



Orlando

2024 Resource Guide



ENGAGE

CONNECT

2024 OFFICERS & DIRECTORS

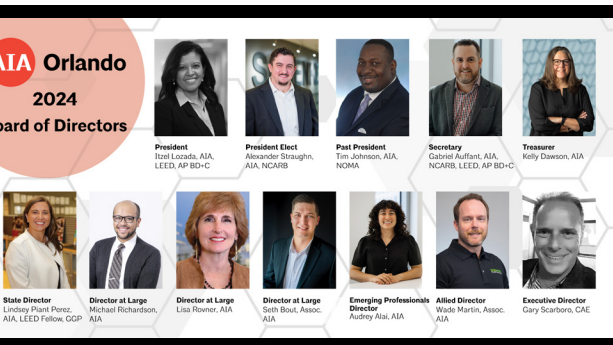

Itzel Lozada, AIA, LEED AP BD+C – President
Alexander Straughn, AIA, NCARB – President Elect
Tim Johnson, AIA, NOMA – Past President
Kelly Dawson, AIA – Treasurer
Gabriel Auffant, AIA, NCARB, LEED, AP BD+C – Secretary
Lindsey Paint Perez, AIA, LEED Fellow, GGP – State Director
Lisa Rovner, AIA – Director at Large
Michael Richardson, AIA – Director at Large
Seth Bout, Assoc. AIA – Director at Large
Audrey Alai, AIA – Emerging Professionals Director
Wade Martin, Assoc. AIA – Allied Director
Gary Scarboro, CAE – Executive Director
Fred Mohre, Pearson Doyle Mohre & Pastis LLP – General Counsel

2024 COMMITTEE CHAIRS



John Adams, AIA, NCARB – Academy for Architecture for Health
Wade Martin, Assoc. AIA – Allied Professionals
Anne Briggs, AIA, LEED AP BD+C, WELL AP – Awards & Recognition
Tim Johnson, AIA, NOMA – Golf Tournament
Aranya Mom, AIA, LEED AP & Maya Joannides, AIA – Government Affairs
Gary Scarboro, CAE (Liasion) – Public Outreach
Kelly Dawson, AIA – Planning
John Dietz, AIA, NCARB – Themed Entertainment & Hospitality
Angelica Corredor, Assoc. AIA – Women in Architecture
Audrey Alai, AIA – Young Architects Forum
Keith Lashley, AIA – Equity Diversity & Inclusion
Kim Garcia (Liasion) – Membership
Arlenne Gil, AIA, NCARB – Academic Alliance

AIA ORLANDO

Gary Scarboro, CAE – Executive Director
Kim Garcia – Chapter Coordinator
Dean Hill – Chapter Coordinator
Ellie Morgan – Chapter Coordinator/Graphic Designer
Katie Sanchez – Chapter Coordinator
625 Virginia Dr. | Orlando FL 32803
Telephone: 407.898.7006 | www.aiaorlando.com

AIA FLORIDA

The American Institute of Architects
104 East Jefferson Street | Tallahassee, FL 32301
Telephone: 850.222.7590 | www.aiafla.org

AIA NATIONAL

The American Institute of Architects
1735 New York Ave NW | Washington, DC 20006-5292
Telephone: 800.AIA.3837 | www.aia.org



MEMBERSHIP

BECOME AN AIA MEMBER

For more than 150 years, members of the American Institute of Architects have worked together with their communities to create valuable, healthy, secure, and sustainable buildings and cityscapes. The American Institute of Architects exists to create opportunities for professional development and fellowship, as well as raise awareness of the architecture profession in the community.

Membership Types:

Architect Member
Associate Member
Allied Member

Associate New Graduate
International Member
Emeritus Member

ALLIED MEMBER

Allied Members are employed outside of traditional architectural practice, but are involved in positions related to the field.

They have an established professional reputation & include engineers, planners, landscape architects, marketing professionals, those involved in manufacturing & sales of products & materials.

Cost:

\$2,500 Premier Partner: Includes Corporate Membership and an all-inclusive marketing package

\$2,500 Select Membership: Includes Corporate Membership, tickets to attend, exhibit and sponsor events and more...

\$500 Corporate Membership: Up to 3 representatives per company and 3 listings on our Allied Directory

\$200 Individual Membership: Includes 1 company representative and 1 listing on our Allied Directory

We will pro-rate all memberships to expire automatically on December 31st. For more information, please contact kim@aiaorlando.com

PREMIER PARTNERSHIP

Premier Partners are AIA members of all categories that want to support the bold strategic goals and mission of the organization while boosting their own brand visibility and recognition at EVERY AIA Orlando event, publication & media.

SELECT MEMBERSHIP

Includes a corporate membership, marketing package, tickets to attend and sponsor key events, a booth and a class at the Annual Conference & Expo and much more...

Premier Partnership includes:

- Corporate Allied Membership
- A perpetual place on the home page of our website including hyperlink (19,000 visitors/year)
- Logo on our weekly E-Charrette including hyperlink (57,000 impressions/year)
- Logo on Stand Up Banner
- Logo on all Board of Director's packets (cover page)
- Logo on all programs and printed publications
- Free tickets to attend the Board Induction
- Free tickets to attend the Annual Meeting and Lecture
- First right of choice for booth(s) at the Conference & Expo

Select Membership includes:

- Corporate membership: \$500
- Select Sponsor at the Board Induction: \$250 (Includes attendee ticket)
- Select Sponsor at the Annual Meeting & Lecture: \$250 (Includes attendee ticket)
- ¼ page Ad on the Member Resource Guide: \$300
- Allied Advantage Coffee Time Host- \$250 (Includes 2 attendee tickets)
- E-Charrette Announcement with hyperlink: \$200
- Conference & Expo standard booth and class \$1,500 (Includes 2 exhibitor tickets and two class presenter tickets)

For more information and to multiply your brand exposure immediately, please contact kim@aiaorlando.com

ENGAGE

COMMITTEES

AIA Orlando has several working committees that provide a mutually beneficial experience. By joining a committee, you get involved in an area of personal interest, gain an outlet for things you are good at but may not have a chance to do in your work, build your professional network, create strategies to grow & develop the architecture & design community in Central Florida, meet new people & have fun interacting, brainstorming & working with others.

Academic Alliance

The Academic Alliance Council brings together representatives from Orlando's collegiate architecture programs, along with AIA and AIA members to help foster the transition of students into industry professionals.

Contact:

Arlenne Gil, AIA, NCARB
agil@dlrgroup.com

Academy of Architecture for Health

Professionals working in the healthcare design field for professional development & education.

Contact:

John Adams, AIA, NCARB
Chair
jadams@ktharch.com

Allied Professionals

Members with a vested interest in the architectural industry who plan fun events & programs.

Contact:

Wade Martin, Assoc. AIA
Allied Director
awmartin@batson-cook.com

Awards and Recognition

Architects, designers, & community volunteers who plan, coordinate & host AIA Orlando's annual Excellence in Design Awards Gala.

Contact:

Anne Briggs, AIA, LEED AP BD+C, WELL AP
Chair
anne.briggs@littleonline.com

Equity Diversity & Inclusion

Supports and celebrates our members, employees, and partners regardless of national origin, language, race, color, disability, ethnicity, gender identity, age, sexual orientation, religion, or socioeconomic status.

Contact:

Keith Lashley, AIA
Chair
klashley@hksinc.com

Golf Tournament

Coordinates & hosts an annual fundraising tournament that brings architects together with allied professionals.

Contact:

Tim Johnson, AIA, NOMA
Chair
tjohnsonarch@gmail.com



COMMITTEES

AIA Orlando has several working committees that provide a mutually beneficial experience. By joining a committee, you get involved in an area of personal interest, gain an outlet for things you are good at but may not have a chance to do in your work, build your professional network, create strategies to grow & develop the architecture & design community in Central Florida, meet new people & have fun interacting, brainstorming & working with others.

Government Affairs

Strengthens the voice of the architectural profession through the engagement of legislators on issues that affect architects.

Contact:

Aranya Mom, AIA, LEED AP &
Maya Joannides, AIA
Co-Chairs
amom@dlrgroup.com

Public Outreach

Represents the interest of architecture in our communities through media relations with the opportunity for local media to promote architecture and design

Contact:

Gary Scarboro, CAE
Liaison
gary@aiaorlando.com

Women in Architecture

Develops and promotes female leaders within the architecture profession, with a focus on mentorship, licensure, and networking opportunities in architecture and the allied design and building industries.

Contact:

Angelica Corredor, Assoc. AIA
Chair
angelica.corredor@c-p.com

Membership

Promotes increased membership in both the architectural community and the allied community & reviews and enhances benefits to all membership sectors.

Contact:

Kim Garcia
Liaison
kim@aiaorlando.com

Themed Entertainment & Hospitality

Integrates the architectural professionals with themed entertainment and hospitality sectors and provides an interactive venue and knowledge-base for the exchange of ideas and new developments.

Contact:

John Dietz, AIA, NCARB
Chair
john.dietz@aecom.com

Young Architects Forum

Group of architects, design professionals & students who are interested in design, professional development, community & collaboration.

Contact:

Audrey Alai, AIA
Chair
aalai@huntonbrady.com

Planning

Works collaboratively to plan quality lectures, events, tours, and continuing education seminars for AIA Orlando members and the community at large.

Contact:

Kelly Dawson, AIA
Chair
kelly.dawson@stantec.com



Super Wideck®

Long-Spanning Roof and Floor Deck Ceiling Systems

EPIC METALS® 

877-696-3742 toll-free epicmetals.com

Universal's Endless Summer Resort - Surfside Inn and Suites - Orlando, FL
Products: SW9K Architect: Lindsay Pope Bayfield & Assoc., Inc. - Lawrenceville, GA

Aurora InfoTech
Cybersecurity & IT Consulting

ARCHITECTS & ENGINEERS

IS YOUR TEAM CYBER-READY TO DEFEND AGAINST THREATS?

In an era where digital landscapes evolve rapidly, fortifying your business against cyber threats is non-negotiable. Our comprehensive Level 1 IT Security Risk Assessment is your shield against unseen vulnerabilities.

\$599.99 OFF
LEVEL 1 IT SECURITY RISK ASSESSMENT

MSSP Alert
THE **TOP 250 MSPs**
2022 EDITION

DO YOU THINK YOUR BUSINESS IS TOO SMALL FOR A CYBER ATTACK?

● Call Now At (407) 995-6766
● www.aurora-infotech.com

- High strength-to-mass ratio stud or joist
- Increases efficiency for mechanical, electrical and plumbing trades

QUALITY

- Drywall stud that increases rentable/saleable floor space
- Does not require additional bracing or resilient channel to achieve high STC ratings

SOUND GUARD

- Joint protection that is fast to install and easy to inspect
- Unlimited shelf-life and no hardening of the material over time

SOLUTIONS

INCREASE EFFICIENCY AND PERFORMANCE WITH MARINOWARE® FRAMING SOLUTIONS

For over 30 years, MarinoWARE® has been a trusted partner to the construction industry. Our dedication to quality cold-formed steel framing products has led to a comprehensive collection of innovative products and solutions designed to streamline the construction process by saving time, labor, and materials.

Visit MarinoWARE.com to experience our full line of innovative solutions.

Kerry McMan
Architectural Sales Representative
kmcman@marinoware.com | 732.856.6115



MARINOWARE
MarinoWARE.com



EMPOWER

EDUCATION

Pre-Licensing



YAF - A.R.E Study Sessions

Join us for a morning lecture and study session prepping you for the ARE exams! We will have Licensed Architects giving specific test prep strategies and answering any tough questions you may have. All sessions will feature small groups that focus on each of the 5.0 Exams in an order that will help facilitate each member's path to licensure.

2+2+2 Program

AIA Orlando and The Orlando Foundation for Architecture provide college scholarships to students that participate in the 2+2+2 program at Valencia College, UCF and UF CityLab Orlando. The scholarship program is available to high-achieving students with financial need who seek to attend and graduate from the nation's first 2+2+2 architectural degree program right here in Orlando.

Continuing Education

Continuing education is required for all registered architects who practice in the state of Florida and are members of AIA. The Florida Statutes require architects to complete continuing education for licensure, while the AIA requires it for membership. Each is recorded separately, but can be interchanged, within certain guidelines.

The state of Florida requires 24 CEUs, with 22 hours in HSW and 2 hours in Advanced Building Code biannually of every odd year. AIA requires 18 LU Hours, with 12 hours in HSW annually, due the end of the calendar year. To obtain HSW credits, members must take courses through AIA CES registered Providers.

Credit Provider

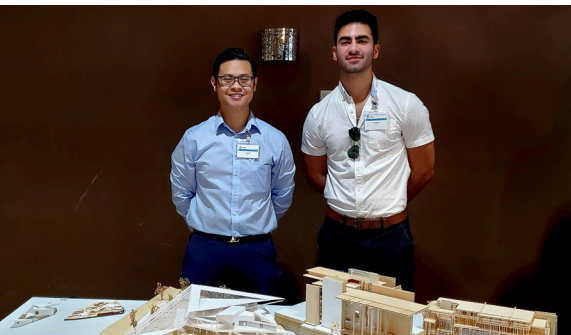

If you have a course that is approved for AIA CEUs, we can assist you by hosting your training session. If you need help getting a course approved, visit www.aiaorlando.com/lunch-learns. Once you register and offer a course for AIA CES LU's, it is your responsibility to record and report AIA member credit information within 10 business days of course completion using the Course Attendance Form. Providers must report AIA member credit information each time a course is offered.

There are two (2) types of learning units/ credit designations:

1. General Learning Units (LU): All approved provider courses are eligible for general course LU's. General course LU's are reserved for courses on a wide range of topics related to A/E/C profession, in which 75 percent of the course content is not related to HSW topics.
2. Health, Safety and Welfare (HSW or as listed in CES Discovery as LU/ HSW): For a provider to offer LU/HSW designated courses it must meet all of the criteria outlined in the HSW section of the manual and be registered as such. HSW courses tend to be in demand. For more information visit www.aiaorlando.com, scroll over Education and select Credit Provider.

EMPOWER

PROFESSIONAL DEVELOPMENT

Lunch & Learns

Lunch & Learns are a great opportunity for our members to get an in-depth look into related industry practices, products and innovations.

We strive to have all our courses accredited by AIA so that our attendees can achieve CEUs (Continuing Education Units), including valuable HSW credits.

For more information or to check for schedule availability, visit www.aiaorlando.com/lunch-learns

A.R.E. Prep

Join us for a morning presentation and study session prepping you for the ARE exams! We will have Licensed Architects giving specific test prep strategies and answering any tough questions you may have. These sessions will feature an introductory presentation and then break into smaller groups that focus on each of the Exams in an order that will help facilitate each member's path to licensure.

Mentoring

AIA Orlando provides many opportunities for students, AIAS members, and Emerging Professionals to get real world mentoring through specific activities and programs designed through the cooperation of the Young Architects Forum (YAF) and Fellows of the American Institute of Architects (FAIA). For more information, please contact the AIA Orlando offices or visit www.aiaorlando.com

Career Center

AIA Orlando's Career Center is your ideal solution for architectural firms and professionals. Members: Post a job- \$40. Post a resume- FREE. Browse resumes- FREE. To search for architects, employees, resumes, jobs, and to post jobs on the AIA Orlando's Career Center for Architecture, visit and click on Careers at www.aiaorlando.com/careers

AIA Career Center

To find/post jobs nationally, visit www.careercenter.aia.org/jobs

AIA University

AIAU brings the industry's best learning to you. Our 300+ instructors are from leading firms and will immerse you in in-demand topics that will boost your skills and portfolio. To learn more, visit www.aiau.aia.org

AIA Contract Documents

Choose from 180+ industry standard construction contracts and forms. AIA Contract Documents® and the content therein are copyrighted works owned by The American Institute of Architects. AIA Contract Documents are protected by U.S. Copyright Law and International Treaties. To find/download documents, visit www.aiacontracts.org/find

www.aiaorlando.com/careers



EMPOWER

EVENTS



Allied Advantage Breakfast

**2nd Wednesdays
8:00 am–9:00 am**

AIA Orlando hosts a monthly Allied Advantage Breakfast, featuring an Architecture Firm of the Month, on the 2nd Wednesday of each month! These breakfasts allow our Allied Members to learn about various local firms and potentially build future business relationships. It is beneficial for both the Allied Members, as well as the presenting architecture firms, as this will allow firms to answer the many questions our Allied Members have to better their service to our local firms.

Each month's featured firm will host a small presentation about the company, the markets they focus on and any other item they find appropriate to share about their companies. This will give our Allied Members information on what would be required to do be considered as a potential vendor on their various upcoming projects. Don't miss this exclusive opportunity to get in-depth, insider insight and access to future opportunities!



A.R.E. Study Sessions

Visit www.aiaorlando.com for dates and times.

Join us for A.R.E study sessions as you are prepping for your exams. We will have Licensed Architects giving specific test prep strategies and answering any tough questions you may have. All sessions will feature small groups that focus on each of the Exams in an order that will help facilitate each members path to licensure.



Building Tours

Visit www.aiaorlando.com for dates and times.

Take an in-depth tour of various facilities throughout Central Florida, sometimes even before they open to the public and learn about their history, architectural influences, construction challenges, functionality and applications, and latest technologies as we go behind the scenes for an immersive experience.

www.aiaorlando.com/calendar

EMPOWER

EVENTS

Lunch and Learns



Visit www.aiaorlando.com for dates and times.

Lunch and learns are a great opportunity for our members to get an in-depth look into related industry practices, products and innovations. We strive to have all our courses accredited by AIA so that our attendees can achieve CEUs (Continuing Education Units), including valuable HSW credits.

Education providers to qualify your presentation, you must:

- Be a member in good standing
- Submit brief description of the course, including (4) learning objectives

Legislative Days



January 22nd & January 23rd, 2024
Tallahassee, FL

AIA Florida Legislative Days will take place on January 23rd in Tallahassee's Capitol complex. The face-to-face meetings with Florida legislators are back this year! We are thankful to have the opportunity to engage with the legislators to advocate for our profession. We hope to be represented with a large AIA Orlando contingent in a return to the Capitol.

Golf Tournament



Friday, February 2nd, 2024
7:00 am-2:00 pm
Eagle Creek Golf Club

The Annual Golf Tournament brought architects and design professionals together with vendors and allied professionals from A/E/C industries for a day of friendly competition to raise scholarship funds for students facing financial hardship. Proceeds from the tournament benefit continuing education programs and scholarships for students studying architecture in America's only 2+2+2 architectural degree program. The Orlando Foundation for Architecture (OFA) works with AIA Orlando on these events to fund the scholarship program every February.

www.aiaorlando.com/calendar



EMPOWER

EVENTS

Mini-Golf Tournament



Saturday, March 9th, 2024
10:00 am-12:00 pm
Lost Caverns Adventure Golf

The Annual Mini Golf Tournament is a family-friendly morning of putt-putting around to benefit Orlando's students of architecture. The mini golf tournament brings students, architects, and design professionals together with vendors and allied professionals for a round of family-friendly competition and networking to raise scholarship funds. Proceeds of the tournament benefit continuing education programs and scholarships for students studying architecture in America's only 2+2+2 architectural degree program every March.

Conference & Expo



Thursday, September 12th, 2024
DoubleTree by Hilton Orlando Downtown

The AIA Orlando Conference and Expo is where our industry professionals have an opportunity to earn valuable CEUs, including Advanced Building Code, in one easy and convenient setting. Experience some of the latest products, innovations & services at the Annual Expo. Student programs and exhibits are featured.

Our Community Corridor includes other non-profit organizations that serve the AEC community.

Annual Meeting & Lecture



Thursday, September 12th, 2024
DoubleTree by Hilton Orlando Downtown

AIA Orlando Chapter's official annual meeting where the elections for board positions takes place and the membership gets an official progress report on the chapter. Members will be voting and there will be a special keynote speaker.

This is an exciting and engaging event. Appetizers and drinks will be provided.

www.aiaorlando.com/calendar

EMPOWER

EVENTS

Design Awards Gala

Friday, April 26, 2024

6:00 pm-10:00 pm

Dr. Phillips Center for the Performing Arts

AIA Orlando's annual Design Awards Gala is one of Florida's most prestigious and inclusive design honors; bringing together architects, designers, and allied professionals in a celebration of exemplary design for both theoretical and built projects.

The design competition highlights the area's best architects, designers, and allied professionals, providing them recognition, publicity, press coverage, and exhibition.



OFA Art Show

November 22nd - December 13th, 2024

City Arts Downtown Orlando

Orlando Foundation for Architecture

The OFA Art Show is an event where artists are encouraged to exhibit and invite their family and friends. The art will be sold and part of the proceeds will benefit the Orlando Foundation For Architecture.



Board Induction & Holiday Party

Friday, December 6th, 2024

6:00 pm-9:00 pm

Casa Feliz

We will welcome the upcoming year's Board of Directors, learn about AIA Orlando Committees, mingle with peers in the festive holiday season. The AIA Orlando/OFA Board Inductions take place in an evening of fun where all members enjoy networking while learning about the many committee participation opportunities within the chapter. This is the perfect opportunity to build connections and to get involved with the organization!





ADVOCATE

AIA LEADERSHIP SUMMIT

AIA Leadership Summit brings together AIA volunteer leaders, chapter executives, and chapter staff across regions, specialties, firm sizes, and career stages. This year's theme—Architecture's Generations at Work—focused on building bridges to create a better world and a stronger profession, skills you can apply to every facet of your professional life.

GOVERNMENT AFFAIRS

AIA Orlando needs members to take the lead for advocacy in their local communities to strengthen the voice of the architectural profession. Through the collaboration of legislators and staff, AIA members share information on issues that affect architects. Some of the key areas of focus for the Government Affairs Committee include growth management, historic resources, school construction, & urban design.

AIA FLORIDA MAJOR EVENTS & MEETINGS

July 26th–30th

AIA Florida Convention & Trade Show
Palm Beach, FL

AIA NATIONAL MAJOR EVENTS & MEETINGS

February 27th – March 1st

AIA Leadership Summit
Washington D.C.

June 5th – 8th

AIA 24 Conference on Architecture and
Design
Washington D.C.

AIA Florida

850.222.7590
104 East Jefferson Street
Tallahassee, FL 3230
www.aiafla.org

AIA National

800.AIA.3837
1735 New York Ave NW
Washington, DC 20006
www.aia.org

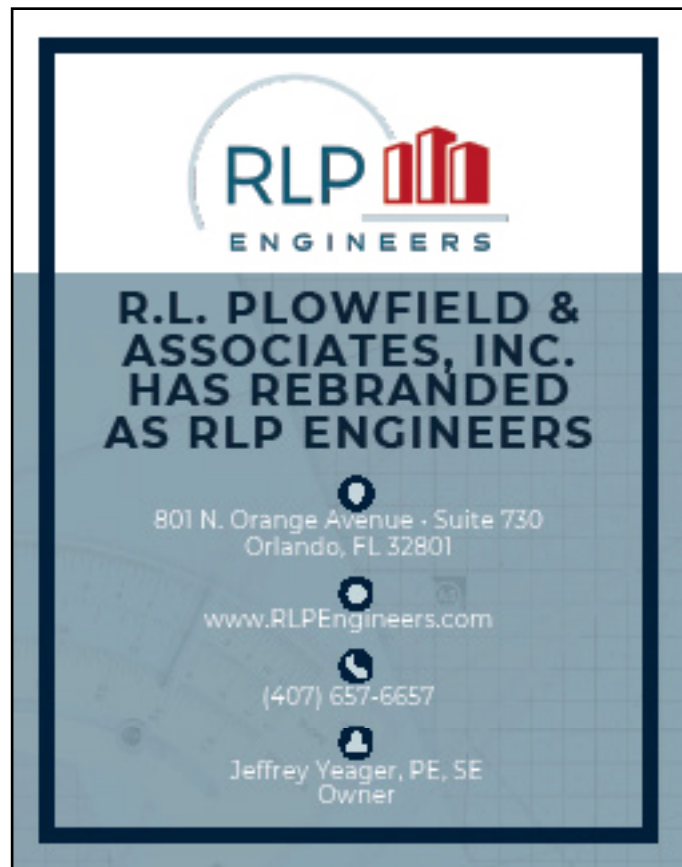

ADVOCATE



ORLANDO FOUNDATION FOR ARCHITECTURE

Orlando Foundation for Architecture



The Orlando Foundation for Architecture is a non-profit organization dedicated to public education that inspires people to discover WHY DESIGN MATTERS.*

The Foundation provides college scholarships to students that participate in the 2+2+2 program at Valencia College, UCF and UF CityLab Orlando.

Through educational programs, tours, exhibits, and events, the Orlando Foundation for Architecture promotes public understanding and appreciation of architecture and design. It inspires creativity and exploration of architecture, engineering, and design. Programs, exhibitions, and events take place at AIA Orlando and community sites throughout Central Florida.

Board of Trustees

Chair

Debra Lemons, AIA, NCARB, IIDA

Treasurer

Mark Adams, AIA, NCARB

Secretary

Malcolm Jones, AIA

Trustee

Kyle O'Connell, AIA

Trustee

Stephen Bender, AIA

Trustee

Jennifer Fritz-Hunter, AIA

Trustee

Nathan Butler, FAIA, LEED AP

Executive Director

Gary Scarboro, CAE

Mission

The Orlando Foundation for Architecture's purpose is to promote public awareness, appreciation and enjoyment of the built environment, advocate for the preservation of historic architecture, demonstrate sustainable practices, offer scholarships for architectural education, and promote diversity in the architectural community.

*Orlando Foundation for Architecture is a 501c3 non-profit organization



www.orlandoarchitecture.org



ADVOCATE



ORLANDO FOUNDATION FOR ARCHITECTURE

Orlando Foundation for Architecture



Become a Member

OFA Membership Levels-

- **Student**- \$25
- **Individual**- \$50
- **Couple**- \$75
- **Friends & Family**- \$150
- **Company Bronze**- \$500
- **Company Silver**- \$1,000
- **Company Gold**- \$2,500
- **Company Platinum**- \$5,000

Attend a Program

OFA provides a comprehensive schedule of programming that connects people of various backgrounds & interests to the exciting world of architecture & design. Programs are available for personal enrichment and/or professional growth. Programming areas focus on design, new construction, historic preservation, environmental sustainability, design for improved health, community culture & identity, and featured works of member architects and firms.

Committees

• Communications

Contact:
Mark Adams, AIA
Committee Chair
madams@eleven18architecture.com

• Events

Contact:
Greg Stock, AIA
Committee Chair
gregory.stock@stantec.com

• Membership

Contact:
Nathan Butler, FAIA, LEED AP
Co-Chair
nbutler@hksinc.com

Stephen Bender, AIA
Co-Chair
sbender@ufl.edu

• Scholarships

Contact:
Debra Lemons, AIA
Committee Chair
dlemons@l2studios.com

• Tours

Contact:
Jacki Hale, FAIA
Co-Chair
jacki.hale.ea@gmail.com

Jennifer Fritz-Hunter, AIA
Co-Chair
Hunter@cityoforlando.net

• OCAD Task Force

Contact:
Gary Scarboro, CAE
Executive Director
gary@aiaorlando.com

• Outreach

Contact:
Dean Hill, ASLA, CGP
Liaison
dean@aiaorlando.com

www.orlandoarchitecture.org

ARCHITECT'S ALLIED DIRECTORY

ACCOUNTING

Bravo Unlimited

Julie Hoffmeyer
407-690-7697
julieh@bravobusiness.net
www.bravobusiness.net

ACOUSTICAL CEILINGS

Rockfon

Amy Neumann
813-334-2075
Amy.Neumann@Rockfon.com
www.rockfon.com

ARCHITECTURAL PRODUCTS: SOUND ABSORPTION & GLASS

The Allyn Rae Group

Sonya Aquino
410-258-9661
saquino@allynraegroup.com
www.allynraegroup.com

ARCHITECTURAL ROOF

EPIC Metals

Alex Burg
412-351-3913
aburg@epicmetals.com
www.epicmetals.com

ARCHITECTURAL STONE CLADDING & COMPONENTS

Pioneer Stone/J & N Stone Inc

Abraham Calas
352-208-7470
abe@pioneerstone.com
www.pioneerstone.com

Stone Tile Group

Maria Isabel Malo
407-232-9812
Maria@stonetilegroup.com
www.stonetilegroup.com

ASSOCIATIONS: METALS & STRUCTURAL

American Institute of Steel Construction

Larry Flynn
312-731-7511
flynn@aisc.org
www.aisc.org

ATTORNEY

Pearson Doyle Mohre & Pastis, LLP

Fred Mohre
407-647-0090
fmohre@pdmplaw.com
www.pdmplaw.com

BANK

Ameris Bank

Rebecca York
407-404-0245
rebecca.york@amerisbank.com
www.amerisbank.com



BOS HAWORTH
A Best in Class Dealer

CONTACT
407.805.9911
orlando@bos.com

- Furnishings
- Installation Services
- Demountable Walls, Interior Glass Wall Products
- Workspace Consultation
- Decommissioning & Trade In
- Technology Integration
- Design Services
- Leasing & Rental
- Culture & Change Communication
- Project Management
- Architectural Interiors

ORLANDO & CENTRAL FLORIDA **BOS** INSPIRING WORKSPACE FURNISHINGS 200 TECHNOLOGY PARK, SUITE 1020 LAKE MARY, FL 32746



ANSER ADVISORY
Part of Anamorphic

OUR SERVICE SECTORS INCLUDE:

- Aviation
- Commercial
- Education
- Energy
- Government
- Hospitality
- Housing
- Industrial
- Infrastructure
- Transportation

COST ESTIMATING GROUP

When it comes to cost estimating for construction projects or capital programs, we make the complex simple!

CONTACT US

costestimating@anseradvisory.com

www.anamorphic.com

12015 Orange Park Blvd, Suite 100
Gaines, FL 32608

EVERY GREAT PROJECT STARTS WITH A GREAT ESTIMATE



ARCHITECT'S ALLIED DIRECTORY

BUILDER

WELBRO Building Corp

Barbara Bombalier
407-475-0800
bbombalier@welbro.com
www.welbro.com

BUILDING ENVELOPE COMMISSIONING/INSPECTIONS

Paramount Consulting & Engineering, LLC

Frankiana Bencosme
305-698-0550
frankiana.bencosme@paramountce.com
www.paramountce.com

BUILDING MATERIALS: SOLID SURFACES, LAMINATES & WOOD PRODUCTS

Dixieply Orlando

Nelsy Leyba
407-619-2323
nvleyba@dixieply.com
www.dixieply.com

BUILDING PRODUCTS

TechWood

Tom Comery
954-639-4869
cassidy@chemtechholding.com
www.chemtechholding.com

CEILINGS

Rockfon

Amy Neumann
813-334-2075
Amy.Neumann@Rockfon.com
www.rockfon.com

USG

Bill McConnaughey
407-883-3977
wmconnaughey@usg.com
www.usg.com

CIVIL ENGINEERING

AVCON, INC.

Rick Baldocchi, PE
407-599-1122
rbaldocchi@avconinc.com
www.avconinc.com

Graef-USA Inc.

Scott Hinrichs, P.E.
407-659-6500
scott.hinrichs@graef-usa.com
www.graef-usa.com

Harris Civil Engineers LLC

Laurie Orlando
407-629-4777
laurieo@harriscivilengineers.com
www.HarrisCivilEngineers.com

CLOSETS & HOME ORGANIZATION

Closet Maid

George Hanus
407-587-4812
george.hanus@closetmaid.com
www.closetmaidpro.com

COATINGS

Arkema

Ron Partridge
484-678-7243
ron.partridge@Arkema.com
www.kynaraquatec.com

PTF Industrial Coatings

Michael Shettler
931-257-1545
m.shettler@PTFCoatings.com
www.ptfcoatings.com

Rainguard Pro

Lisa Goodwin
813-564-2178
lisa@rainguardpro.com
www.rainguardpro.com

COLD FORMED STEEL FRAMING

Marino\Ware

Kenny McMann
732-956-6115
kcmcmann@marinoware.com
www.marinoware.com

COMMERCIAL GENERAL CONTRACTOR

Turner Construction Company

Andrew Gotschall
786-352-7435
agotschall@tcco.com
www.turnerconstruction.com

WELBRO Building Corp

Barbara Bombalier
407-475-0800
bbombalier@welbro.com
www.welbro.com

COMMISSIONING & ENERGY ENGINEERING

Matern Professional Engineering

Ryan Strandquest
407-740-5020
rstrandquest@matern.net
www.matern.net

TLC Engineering Solutions

Christina Scott
407-841-9050
christina.scott@tlc-eng.com
www.tlc-eng.com

COMPLIANCE

Aurora InfoTech, LLC

Carmela Sanchez
(407) 995-6766
carmelasanchez@aurora-infotech.com
www.aurora-infotech.com

CONSTRUCTION

Batson Cook Construction

Eric Clayton
904-265-3444
eclayton@batson-cook.com
www.batson-cook.com

ARCHITECT'S ALLIED DIRECTORY

Mickey Ellison

Mickey Ellison
321-403-9120
mellison@kinleyfl.com
www.kinleyfl.com

Turner Construction Company

Andrew Gotschall
786-352-7435
agotschall@tcco.com
www.turnerconstruction.com

WoodWorks - Wood Products Council

Jeff Peters, PE, CGC
386-871-8808
jeff.peters@woodworks.org
www.woodworks.org

CONSTRUCTION ENGINEERING

BBM Structural Engineers, Inc.

Karen Petersen
407-645-3423
kpetersen@bbmstructural.com
www.bbmstructural.com

Terracon Consultants, Inc.

Bill Collester
407-607-5502
bill.collester@terracon.com
www.terracon.com

CONSTRUCTION MANAGEMENT

Barton Malow Builders

Michael "Mick" Thornton
407-575-6477
Michael.Thornton@BartonMalow.com
www.BartonMalow.com

Batson Cook Construction

Eric Clayton
904-265-3444
eclayton@batson-cook.com
www.batson-cook.com

CONSTRUCTION MATERIALS

Coastal Construction Products

Austin Ricci
407-849-1717
aricci@CoastalOne.com
www.CoastalOne.com

CONSULTING

WoodWorks-Wood Products Council

Jeff Peters, PE, CGC
386-871-8808
jeff.peters@woodworks.org
www.woodworks.org

CONSULTING ENGINEERING

Applied Technical Services/PENTA

Matthew Landman
407-276-6814
Mlandman@atslab.com
www.atslab.com

Harris Civil Engineers LLC

Laurie Orlando
407-629-4777
laurieo@harriscivilengineers.com
www.HarrisCivilEngineers.com

Matern Professional Engineering

Ryan Strandquest
407-740-5020
rstrandquest@matern.net
www.matern.net

O'Donnell & Naccarato, Inc.

Michael Miller
215-925-3788
mmiller@o-n.com
www.o-n.com

Terracon Consultants, Inc.

Bill Collester
407-607-5502
bill.collester@terracon.com
www.terracon.com

CONTRACT REVIEW

JCJ Insurance Agency

Erin Johnson
321-445-9968
ejohnson@jcj-insurance.com
www.jcj-insurance.com

COST ESTIMATING & COST CONTROL

Anser Advisory

Andy Kleimola
352-801-3602
andy.kleimola@anseradvisory.com
www.anseradvisory.com

COUNTERTOPS: CORIAN ACRYLIC, QUARTZ, PORCELAIN SLABS

Cambria Company LLC

Tanya Barker
407-490-2099
tanya.barker@cambriausa.com
www.cambriausa.com

Cosentino

Ignacio Paniagua Rico
786-635-9603
ipaniagua@cosentino.com
www.cosentino.com

CURTAIN WALL

Sierra Pacific Windows

Roy Williams
239-284-4849
rwilliams@spi-ind.com
www.sierrapacificwindows.com

CYBERSECURITY (MSSP)

Aurora InfoTech, LLC

Carmela Sanchez
(407) 995-6766
carmelasanchez@aurora-infotech.com
www.aurora-infotech.com

DESIGN

WELBRO Building Corp

Barbara Bombalier
407-475-0800
bbombalier@welbro.com
www.welbro.com

DOOR HARDWARE: COMMERCIAL

RHi Associates

Rick Hubbard
407-833-8811
rick@rhi-asc.com
www.rhiassoc.com



ARCHITECT'S ALLIED DIRECTORY

EMPLOYMENT

PGAV

Venita Davidson
314-365-6358
venita.davidson@pgav.com
www.pgav.com

ENGINEERING

BBM Structural Engineers, Inc.

Karen Petersen
407-645-3423
kpetersen@bbmstructural.com
www.bbmstructural.com

Graef-USA Inc.

Scott Hinrichs, P.E.
407-659-6500
scott.hinrichs@graef-usa.com
www.graef-usa.com

Harris Civil Engineers LLC

Laurie Orlando
407-629-4777
laurieo@harriscivilengineers.com
www.HarrisCivilEngineers.com

IMEG, formerly McVeigh & Mangum Engineering

Wayne Mangum
904-631-3491
wayne.d.mangum@imegcorp.com
www.imegcorp.com

Integral Engineering, Inc.

Luis C Correa, P.E., S.I.
813-908-0402
lc@ineng.us
www.integralengineeringinc.com

Langan Engineering

Judge Roach
407-913-4922
jroach@langan.com
www.langan.com

O'Donnell & Naccarato, Inc.

Michael Miller
215-925-3788
mmiller@o-n.com
www.o-n.com

RLP Engineers

Jeffrey Yeager, PE, SE
407-657-6657
jyeager@rlpengineers.com
www.rlpengineers.com

Terracon Consultants, Inc.

Bill Collester
407-607-5502
bill.collester@terracon.com
www.terracon.com

TLC Engineering Solutions

Christina Scott
407-841-9050
christina.scott@tlc-eng.com
www.tlc-eng.com

Wilson & Girgenti

Jose Dominguez
813-855-3330
jdominguez@wilsongirgenti.com
www.wilsongirgenti.com

EXTERIOR AND INTERIOR WALL SYSTEM

Vero Building Products

Dudley Powell
407-621-1958
dudleypow@aol.com
www.verobuildingsystems.com

EXTERIOR TILE

Crossville Studios

Andrew N. Shodis
321-229-3252
ashodis@crossvillestudios.com
www.crossvillestudios.com

FACADE

Cosentino

Ignacio Paniagua Rico
786-635-9603
ipaniagua@cosentino.com
www.cosentino.com

Pioneer Stone / J & N Stone Inc.

Abraham Calas
352-208-7470
abe@pioneerstone.com
www.pioneerstone.com

FALL PROTECTION

HySafe

Jeff Carson
407-592-9560
jcarson@hysafe.com
www.hysafe.com

FENESTRATION

Sierra Pacific Windows

Roy Williams
239-284-4849
rwilliams@spi-ind.com
www.sierrapacificwindows.com

FINISHES & MASONRY

Sto Corp

Clark Larson
407-718-4449
clarson@stocorp.com
www.stocorp.com

UMI Stone

Kate Turner
239-593-6995
kturner@umistone.com
www.umistone.com

FIRE PROOFING

Global Fireproof Solutions, Inc.

Chris Birchfield
877-751-0990
chris@globalfire.us
www.globalfire.us

FIRESTOP PRODUCT DISTRIBUTOR

Coastal Construction Products

Austin Ricci
407-849-1717
aricci@CoastalOne.com
www.CoastalOne.com

FIRESTOP PRODUCT MANUFACTURER

Specified Technologies Inc.

Gene Markievich
727-424-8276
gmarkievich@stifirestop.com
www.stifirestop.com

ARCHITECT'S ALLIED DIRECTORY

FLOORING

Cosentino

Ignacio Paniagua Rico
786-635-9603
ipaniagua@cosentino.com
www.cosentino.com

Coverings 2023

Jamie Rich
571-313-5801
info@coverings.com
www.coverings.com

FLOOR DECK CEILING

EPIC Metals

Alex Burg
412-351-3913
aburg@epicmetals.com
www.epicmetals.com

FURNITURE

BOS Office Furniture

Robert Bagley
678-218-2740
robert.bagley@bos.com
www.bos.com

Steelcase

Mike Desanto
904-808-3689
mdesanti@steelcase.com
www.steelcase.com

Working Spaces

Tyler Smith
407-970-4611
tsmith@wspaces.com
www.wspaces.com

GENERAL CONTRACTOR

Batson Cook Construction

Eric Clayton
904-265-3444
eclayton@batson-cook.com
www.batson-cook.com

CRM Services

Aiden Smith
888-502-5203
asmith@crmservices.us
www.crmservices.us

Miller Construction Company

Jesse Newton
407-580-0456
jnewton@millerconstruction.com
www.MillerConstruction.com

Turner Construction Company

Andrew Gotschall
786-352-7435
agotschall@tcco.com
www.turnerconstruction.com

WELBRO Building Corp

Barbara Bombalier
407-475-0800
bbombalier@welbro.com
www.welbro.com

GRAPHICS

Legion Graphics

Brent Denson
386-529-4007
brent@legiongraphics.com
www.legiongraphics.com

HAND DRYER MANUFACTURER

Excel Dryer

Debbie Frangie
413-525-4531
dfrangie@exceldryer.com
www.exceldryer.com

INSPECTIONS (SPECIAL)

Integral Engineering, Inc.

Luis C Correa, P.E., S.I.
813-908-0402
lc@ineng.us
www.integralengineeringinc.com

INSURANCE & RISK MANAGEMENT

JCJ Insurance Agency

Erin Johnson
321-445-9968
ejohnson@jcj-insurance.com
www.jcj-insurance.com

IT & AV

Jinx-IT

Destry Jinks Sr.
407-574-6978
jinx@jinx-it.com
www.jinx-it.com

IT SERVICES

BrickTech

Mike Jenkins
407-244-4494
Mike.Jenkins@BrickTechIT.com
www.BrickTechIT.com

Jinx IT

Destry Jinx
407-574-6978
jinx@jinx-it.com
www.jinx-it.com

LAW FIRM

Patrick Legal Group, P.A.

Alexis Patrick
407-205-2619
alexis@patricklegalgroup.com
patricklegalgroup.com

Pearson Doyle Mohre & Pastis, LLP

Fred Mohre
407-647-0090
fmohre@pdmplaw.com
www.pdmplaw.com

LEGAL SERVICES

Pearson Doyle Mohre & Pastis, LLP

Fred Mohre
407-647-0090
fmohre@pdmplaw.com
www.pdmplaw.com

LIGHTING

DMF

Mandy Bouton
972-834-8030
mbouton@dmflighting.com
www.dmflighting.com



ARCHITECT'S ALLIED DIRECTORY

Infinity Architectural Lighting of Central Florida

Thomas Wunderlich
689-220-8303
thomas@infinityal.com
www.infinityal.com

Landreth, Inc.

Cassie Wildey
407-810-5175
cwildey@landrethinc.com
www.landrethinc.com

Lighting Partners of Central Florida

Josh Wright
321-689-7522
jwright@lightingpartnerscf.com
www.lightingpartnerscf.com

SESCO Lighting

Jeffrey Crisp
850-251-0069
jcrisp@sescolighting.com
www.sescolighting.com

LIGHTING CONTROLS

Lighting Partners of Central Florida

Josh Wright
321-689-7522
jwright@lightingpartnerscf.com
www.lightingpartnerscf.com

LIGHTING DESIGN

Delos Lighting Studio

Asher Harder
321-521-4156
asher.harder@deloslightingstudio.com
www.deloslightingstudio.com

Lighting Partners of Central Florida

Josh Wright
321-689-7522
jwright@lightingpartnerscf.com
www.lightingpartnerscf.com

MANUFACTURER REPRESENTATIVES

Copeland Architectural Systems

Clyde Copeland
813-831-3344
ccopeland@cas-corp.com
www.cas-corp.com

Dino+Associates

Julie Ninassi
850-319-5119
julie@dino-associates.com
www.dino-associates.com

Harry Warren, Inc

John Daniel
407-421-6198
johndaniel@harrywarren.com
www.harrywarren.com

SSA Manufactures Representatives

Joel Marmion
984-500-6098
joel.marmion@ssafla.com
www.ssafla.com

How can we **support**
your project?

Structural Design Services:

- + New Construction
- + Renovation & Expansion
- + Forensic Analysis
- + Peer Review
- + Facility Assessment
- + Loading Analysis
- + Facade & Garage Restoration
- + Vertical Expansion Analysis

Foundations For **Success**, Structures For **Life**.

O'DONNELL & NACCARATO
STRUCTURAL ENGINEERS

ARCHITECT'S ALLIED DIRECTORY

MECHANICAL, ELECTRICAL & PLUMBING ENGINEERING

AVCON, INC.

Rick Baldocchi, PE
407-599-1122
rbaldocchi@avconinc.com
www.avconinc.com

Matern Professional Engineering

Ryan Strandquest
407-740-5020
rstrandquest@matern.net
www.matern.net

Motz Engineering

Cory St. Clair
407-885-0007
cory@motzengineering.com
www.motzengineering.com

OFFICE FURNITURE

BOS Office Furniture

Robert Bagley
678-218-2740
robert.bagley@bos.com
www.bos.com

PAINT AND COATINGS

Rust-Oleum

Eric Mitchell
407-340-4666
emitchell@rustoleum.com
www.rustoleum.com

PANELING: FIBER & CEMENT

Nichiha

Tim Glowacki
689-231-6355
tglowacki@nichiha.com
www.nichiha.com

PANELS: STRUCTURAL CONCRETE INSULATED

Vero Building Products

Dudley Powell
407-621-1958
dudleypow@aol.com
www.verobuildingsystems.com

PAVERS

Pachyderm

Brian Wolfe
813-464-1610
bwolfe@pmctampa.com
www.pmctampa.com

PHOTOGRAPHY

Harry Lim Photography

Harry Lim
407-953-9896
info@harrylimphotography.com
www.harrylimphotography.com

PLUMBING

LIXIL Americas

Nolan Formato
321-504-8723
nolan.formato@lixil.com
www.lixil.com

Specified Sales Associates

Gordon Roessler
813-230-2848
gordon.roessler@ssafla.com
www.ssafla.com

SSA Manufactures Representatives

Joel Marmion
984-500-6098
joel.marmion@ssafla.com
www.ssafla.com

The CARR Company

Taine Dagostino
407-885-2234
tdagostino@carrcompany.com
www.carrcompany.com

PLUMBING CONTROLS

I-CON Systems

John Cumming
407-255-0123
john.cumming@i-con.com
www.i-con.com

PORCELAIN TILE PANELS

Crossville Studios

Andrew N. Shodis
321-229-3252
ashodis@crossvillestudios.com
www.crossvillestudios.com

PROGRAM CONTROL

Anser Advisory

Andy Kleimola
352-801-3602
andy.kleimola@anseradvisory.com
www.anseradvisory.com

PROGRAM & PROJECT MANAGEMENT

Anser Advisory

Andy Kleimola
352-801-3602
andy.kleimola@anseradvisory.com
www.anseradvisory.com

RAILINGS

Viva Railings

Robin Webb
689-867-1692
rwebb@vivarailings.com
www.vivarailings.com

RAINSCREEN CLADDING SYSTEMS

Taylor Architectural Products Inc

Bob Taylor
813-416-3011
bob@taylor-ap.com
www.taylor-ap.com

RENDERINGS

Genesis Studios

Frank Bartus
407-539-2606
adam@genesisstudios.com
www.genesisstudios.com



ARCHITECT'S ALLIED DIRECTORY

RISK MANAGEMENT

JCJ Insurance Agency

Erin Johnson
321-445-9968
ejohnson@jcj-insurance.com
www.jcj-insurance.com

ROOFING

Siplast

Dylan Kloepfner
904-314-8808
dylan.kloepfner@siplast.com
www.siplast.com

Soprema

Todd Page
407-885-1288
tpage@soprema.us
www.soprema.us

SOUND CONTROL

PROFLEX

Patricia Molnar
321-661-3168
pmolnar@proflex.us
www.proflex.us

STEEL FRAMING

Marino\Ware

Kenny McMann
732-956-6115
kmmann@marinoware.com
www.marinoware.com

STONE

PIONEER STONE/J & N STONE INC

Abraham Calas
352-208-7470
abe@pioneerstone.com
www.pioneerstone.com

STONE WOOL

Rockfon

Amy Neumann
813-334-2075
Amy.Neumann@Rockfon.com
www.rockfon.com

STRUCTURAL ENGINEERING

AVCON, INC.

Rick Baldocchi, PE
407-599-1122
rbaldocchi@avconinc.com
www.avconinc.com

BBM Structural Engineers, Inc.

Karen Petersen
407-645-3423
kpetersen@bbmstructural.com
www.bbmstructural.com

BTS Engineering Consultants Corp

Patricio Romero
407-912-2973
promero@btsengineeringcorp.com
www.btsengineeringcorp.com

Graef-USA Inc.

Scott Hinrichs, P.E.
407-659-6500
scott.hinrichs@graef-usa.com
www.graef-usa.com

Integral Engineering, Inc.

Luis C Correa, P.E., S.I.
813-908-0402
lc@ineng.us
www.integralengineeringinc.com

O'Donnell & Naccarato, Inc.

Michael Miller
215-925-3788
mmiller@o-n.com
www.o-n.com

RLP Engineers

Jeffrey Yeager, PE, SE
407-657-6657
jyeager@rlpengiineers.com
www.rlpengineers.com

TLC Engineering Solutions

Christina Scott
407-841-9050
christina.scott@tlc-eng.com
www.tlc-eng.com

STRUCTURAL LONG-SPANNING DECKS

EPIC Metals

Alex Burg
412-351-3913
aburg@epicmetals.com
www.epicmetals.com

SURFACES (STONE, PORCELAIN, CERAMIC, GLASS)

Coverings 2023

Jamie Rich
571-313-5801
info@coverings.com
www.coverings.com

Stone Tile Group

Maria Isabel Malo
407-232-9812
Maria@stonetilegroup.com
www.stonetilegroup.com

TELECOMMUNICATION (VoIP)

Aurora InfoTech, LLC

Carmela Sanchez
(407) 995-6766
carmelasanchez@aurora-infotech.com
www.aurora-infotech.com

THERMOPLASTIC SINGLE-PLY ROOFING

Duro-Last Roofing, Inc.

William Boyer
989-239-0311
bboyer@duro-last.com
www.duro-last.com

THRESHOLD INSPECTION

RLP Engineers

Jeffrey Yeager, PE, SE
407-657-6657
jyeager@rlpengiineers.com
www.rlpengineers.com

ARCHITECT'S ALLIED DIRECTORY

TILE & STONE

Coverings 2023

Jamie Rich
571-313-5801
info@coverings.com
www.coverings.com

Crossville Studios

Andrew N. Shodis
321-229-3252
ashodis@crossvillestudios.com
www.crossvillestudios.com

Stone Tile Group

Maria Isabel Malo
407-232-9812
Maria@stonetilegroup.com
www.stonetilegroup.com

TRAVEL INDUSTRY

SOLYMAR TRAVEL

Victor Lozada
407-203-5000
vacations@solymartravels.com
www.solymartravels.com

VENUE: HISTORIC HOME / MUSEUM

Casa Feliz Historic Home & Venue

Susan Omoto
407-628-8200
susan@casafeliz.us
www.casafeliz.us

WALL SYSTEMS: EXTERIOR AND INTERIOR

Vero Building Products

Dudley Powell
407-621-1958
dudleypow@aol.com
www.verobuildingsystems

WATER FIXTURES

I-CON Systems

John Cumming
407-255-0123
john.cumming@i-con.com
www.i-con.com

SSA Manufactures Representatives

Joel Marmion
984-500-6098
joel.marmion@ssafla.com
www.ssafla.com

WATER MANAGEMENT SYSTEMS: CONTROLS, VALVES, STAINLESS FIXTURES

I-CON Systems

John Cumming
407-255-0123
john.cumming@i-con.com
www.i-con.com

WATERPROOFING

Coastal Construction Products

Austin Ricci
407-849-1717
aricci@CoastalOne.com
www.CoastalOne.com

GCP

Joel Fernandez
786-835-5674
Joel.Fernandez@gcpat.com
www.GCPAT.com

Pecora Corporation

Sandra D French
610-554-8465
Frenchs@Pecora.com
www.pecora.com

Soprema

Todd Page
407-885-1288
tpage@soprema.us
www.soprema.us

WINDOWS & DOORS

ESWINDOWS

Jack Redden, CSI-CDT
407-480-7385
jack.redden@energiasolarsa.com
www.eswindows.com

Sierra Pacific Windows

Roy Williams
239-284-4849
rwilliams@spi-ind.com
www.sierrapacificwindows.com

WOOD: COMMERCIAL DESIGN SUPPORT

WoodWorks - Wood Products Council

Jeff Peters, PE, CGC
386-871-8808
jeff.peters@woodworks.org
www.woodworks.org

WOOD PRODUCT MANUFACTURING

TechWood

Tom Comery
954-639-4869
cassidy@chemtechholding.com
www.chemtechholding.com

WOOD PROTECTION

TechWood

Tom Comery
954-639-4869
cassidy@chemtechholding.com
www.chemtechholding.com

WOOD TREATMENT

Chemical Technologies Holding Corp

Justine McPherson
772-577-3124
justine@chemtechholding.com
www.techwoodtreatments.com



**Proudly supporting the
AIA mission in **Orlando**
and across the nation.**

MEP | Fire Protection Life Safety | Structural | Technology
Acoustical | Sustainability | Commissioning | Energy Engineering

THINK. LISTEN. CREATE.

tlc-engineers.com

FREE PROJECT SUPPORT / EDUCATION / RESOURCES

**Designing a wood building?
Ask me anything.**



**Jeff Peters, PE, CBC
Regional Director
FL, AL, LA**



2024

AIA Orlando Conference & Expo

Double Tree by Hilton Orlando Downtown
Thursday, September 12, 2024

Thank You to Our Premier Partners!



SSA

People Products Solutions

Coverings

THE GLOBAL TILE & STONE EXPERIENCE



**Crossville
Studios**



SESCO
LIGHTING

www.aiaorlando.com